

# Year 6 Map Skills

UH OH! A first year has gotten lost trying to get to his lessons. Can you help him?

## 1. Compass Directions

a) INSTRUCTIONS: Complete the compass

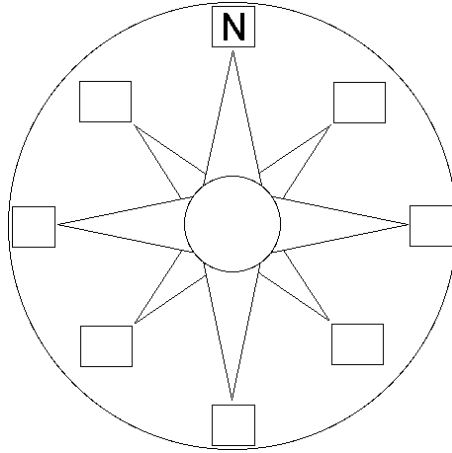

b) INSTRUCTIONS: Use the Hogwarts map. Harry is in the room of requirement. Which direction would he need to go to get to the following places?

1. Hagrid's Hut                      Direction: \_\_\_\_\_

2. History of Magic Class        Direction: \_\_\_\_\_

3. The Owl Tower                  Direction: \_\_\_\_\_

## 2. Directions



Use the map below to complete Harry's timetable helping him get to all of his lessons on time or else he'll have detention with Snape!

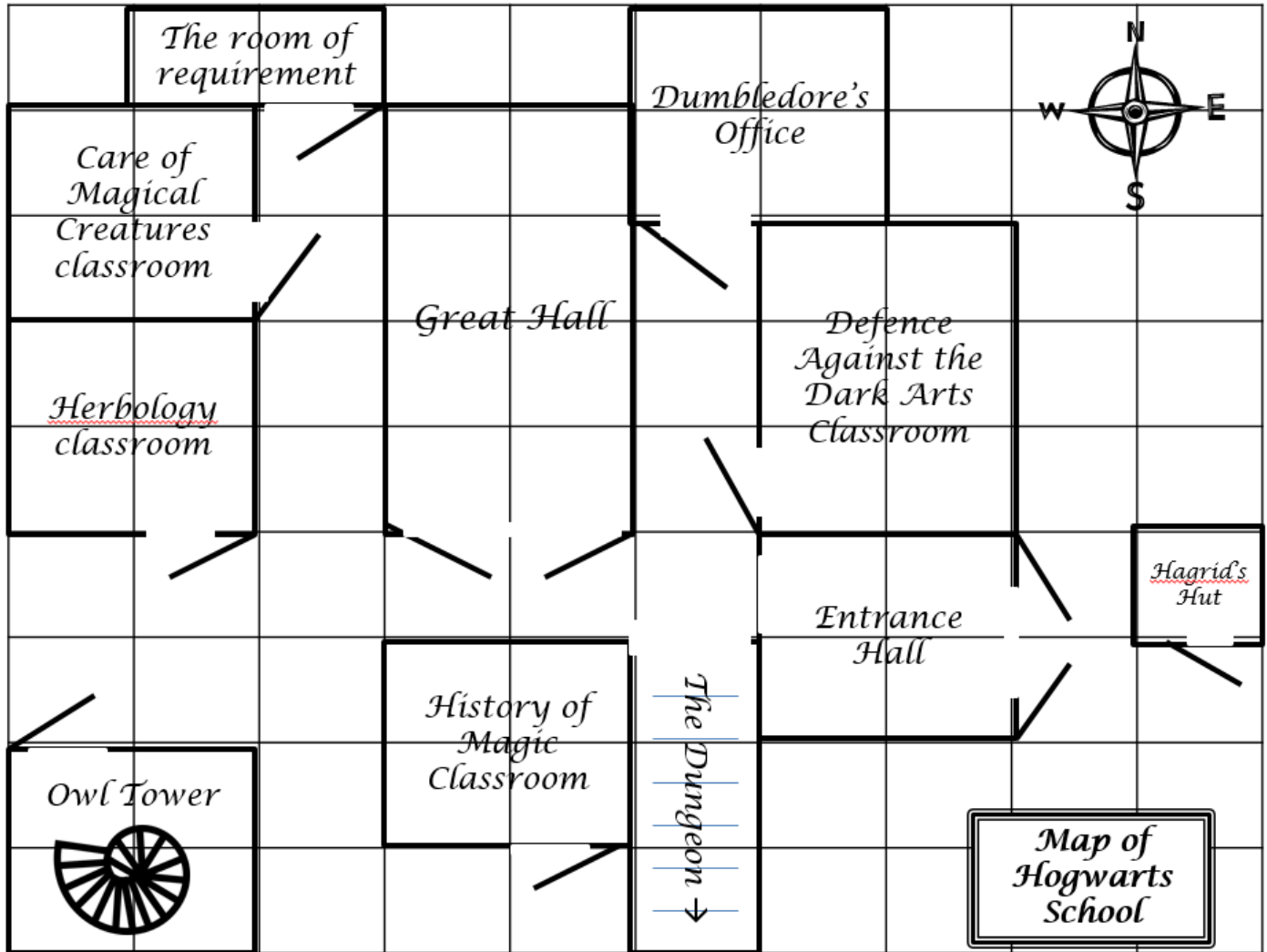

*Timetable for: Harry Potter*

<i>Time</i>	<i>Activity/Room</i>	<i>Directions</i>
08:00	<i>Breakfast in the Great Hall</i>	
09:00	<i>Defence Against the Dark Arts</i>	
10:30	<i>Visit <u>Hagrid</u> in <u>Hagrid's Hut</u></i>	
11:00	<i><u>Herbology</u></i>	
12:00	<i>Lunch in the Great Hall</i>	
1:00	<i>History of Magic</i>	
2:00	<i>Potions in the Dungeon</i>	
3:00	<i>Visit Hedwig in the Owl Tower</i>	
4:00	<i>Meet Dumbledore's Army in <u>The Room of requirement</u></i>	